

FAST™

MODULAR
ACCESSORY
SUITE

USER

INSTRUCTIONS



 **UNITY**

FAST™ Modular Accessories afford several options to attach secondary/back-up optics to compatible FAST™ mounts hosting primary-use optics. The FAST™ Offset Optic Base attaches directly to the FAST™ mount, providing a platform for attaching FAST™ Optic Adapter Plates. FAST™ Optic Adapter Plates can also be mounted to the MRDS Top Ring for the FAST™ LPVO, allowing micro red dots to sit at the 12 o'clock position.

FAST™ Offset Optic Base

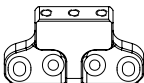

**FAST™ Optic Adapter Plate
ACRO® Footprint**

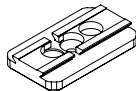

MRDS Top Ring for FAST™ LPVO

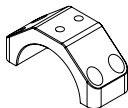

**FAST™ Optic Adapter Plate
Aimpoint® Micro® Footprint**

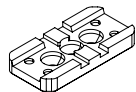

**FAST™ Optic Adapter Plate
DeltaPoint® Pro Footprint**

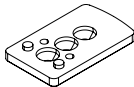

**FAST™ Optic Adapter Plate
509T Footprint**

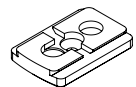

**FAST™ Optic Adapter Plate
RMR® Footprint**

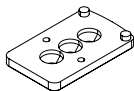

**FAST™ Optic Adapter Plate
RMSc / Holosun™ K Footprint**

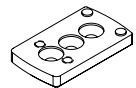

**WARNING:****ENSURE FIREARM IS UNLOADED****CAUTION:**

Over-torquing fasteners can damage your mount and/or your optic and will void your warranty. Using thread locking compounds, such as Loctite® or others, is not recommended and will void your warranty.

ATTACHING YOUR FAST™ OPTIC ADAPTER PLATE TO YOUR FAST™ OFFSET OPTIC BASE

1

Hand-fit the FAST™ Offset Optic Base and FAST™ Optic Adapter Plate in your desired position [Rearward Cantilever, Forward Cantilever or Centered]. If attaching to a FAST™ LPVD, ensure your Scope is already installed to determine placement and forward/rearward bias. Install the FAST™ Optic Adapter Plate to the FAST™ Offset Optic Base with included hardware. Finger tighten and then give each screw a 1/8 - 1/4 turn.

Torque to 18 in-lbs [2 Nm].

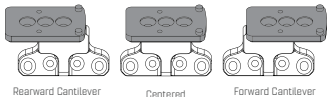
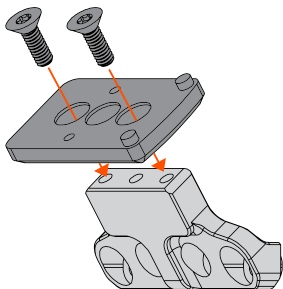

2

Install your Optic to the FAST™ Optic Adapter Plate with included hardware. Finger tighten and then give each screw a 1/8 - 1/4 turn. **Do not exceed manufacturer's recommended torque spec.**

ATTACHING YOUR FAST™ OPTIC BASE TO YOUR FAST™ MOUNT

1

Install completed FAST™ Modular Suite assembly onto your relevant FAST™ mount in desired location with 2x small 6-32 Screws. **Torque to 15 in-lbs (1.7 Nm).**

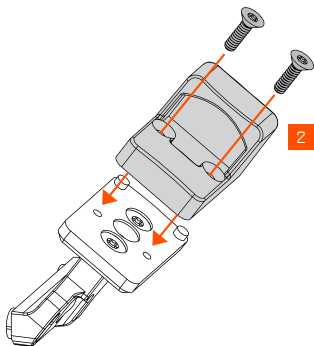

NOTE:

If using the FAST™ Modular Suite assembly on a FAST™ LPVO or FAST™ COG Series, it can be mounted in the front or rear positions (figure A / figure B).

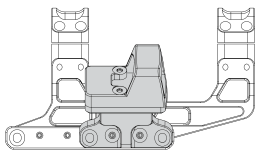
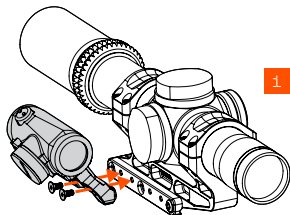

FIGURE A

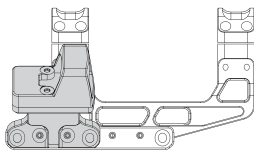
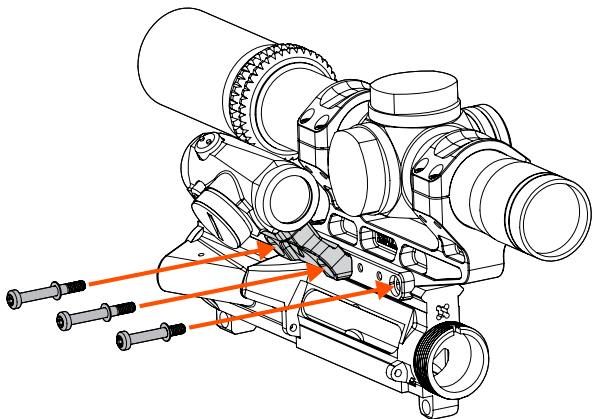

FIGURE B

2

Push mount forward against recoil lug. Place two included longer Clamp Screws through FAST™ Offset Optic Base assembly. Tighten Clamp Screws in order – Front, Rear, Middle – using a T25 bit driver. Lightly snug all screws before applying final torque to any. **Torque to 35 in-lbs [4 Nm].**



ATTACHING YOUR FAST™ OPTIC ADAPTER PLATE TO YOUR MRDS TOP RING FOR FAST™ LPVO

1

Hand-fit the FAST™ Optic Adapter Plate on the MRDS Top Ring for the FAST™ LPVO and install using the included hardware. Finger tighten and then give each screw a 1/8 - 1/4 turn. **Torque to 18 in-lbs [2 Nm].**

ATTACHING YOUR MRDS TOP RING TO YOUR FAST™ LPVD

1

Remove existing Rings Screws on your FAST™ LPVD mount.

2

Install MRDS Top Ring in place of the original Top Ring. Finger tighten all Ring Screws. Ensure Scope is in the proper position for shooter's eye relief.

3

Level Scope reticle. Tighten Ring Screws in the order shown with a T15 bit driver. Lightly snug all screws before applying final torque to any. **Torque in the pattern below to 18 in-lbs (2 Nm).** Complete this pattern two times.

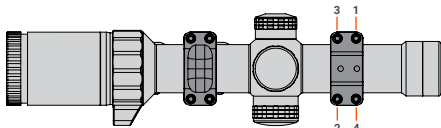
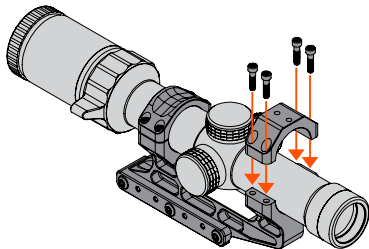

NOTE:

The MRDS Top Ring can be mounted on either ring of the FAST™ LPVD. The Top Rings can be flipped for additional positioning options.

