

FUSION™

SIMPLE. STRONG. CUSTOM.

PATENT-PENDING

FUSION™ is a modular, multi-purpose mount system designed to give the end user extreme flexibility in mounting options. It was engineered from the ground up to provide a strong mounting base with the widest range of configurations while remaining lightweight and inexpensive.

The system consists of a base with several accessories adapters. The current offerings encompass a wide range of current devices to include lights, lasers, optics, and ancillary equipment. Because the mounting system is standardized we are able to introduce new accessory mounts as equipment and TTP's change, reducing time to market and maximizing effectiveness.

FUSION™ was designed to maximize the use of rail space while remaining lightweight and low profile. The hub is constructed from precision milled 6061-T6 aluminum that is then hardcoat anodized in black or FDE for durability. The interface points are very strong and provide for a very rigid mount. The picatinny rail hub has 4 mounting surfaces; a top surface, forward surface, and two wing surfaces. All wing accessories are reversible.

The combination of equipment configurations is immense and we will continue to add accessories to expand the capabilities of the system. The wing accessory adapters are also compatible with our Ops-Core ARC® rail adapter as well as our Tubular Rail Adapter. This allows the use of the same adapters for either a weapon or helmet mounted system to reduce complexity and cost.

We have obsessed over the details of this system for quite some time and it has been tested both in CAD and in the field. We are very excited about this project and are moving into production, with a scheduled release at SHOT Show 2013.

Available Q1 2013. For more information, contact Unity Tactical at info@unitytactical.com



Just a few of the thousands of possible configurations possible with the FUSION™ mount system:



UNITY TACTICAL™

www.UnityTactical.com
www.facebook.com/UnityTacticalLLC



SIMPLE. STRONG. CUSTOM.

OVERVIEW

FUSION RAIL MOUNTED HUB - UT-FUS-HB-RL

SIDE INTERFACE (EITHER SIDE):

LDI Lasers
Surefire Scout Light
Surefire Raid Light
Ring Light Adapter Kit - UT-FUS-SD-L1
Backup Iron Sight - UT-FUS-TP-S1
Extension - UT-FUS-HB-EX
Offset Rail - UT-FUS-SD-R1
Offset Wing Mount - UT-FUS-SD-L5
Offset Optics

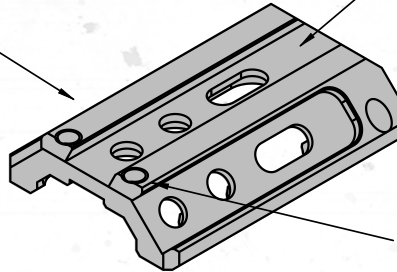

TOP INTERFACE:

LDI Lasers
Surefire Scout Light
Ring Light Adapter Kit - UT-FUS-SD-L1
Backup Iron Sight - UT-FUS-TP-S2
Extension - UT-FUS-HB-EX
Atlas Bipod

FRONT INTERFACE:

Forward Rail - Inline - UT-FUS-FR-R1

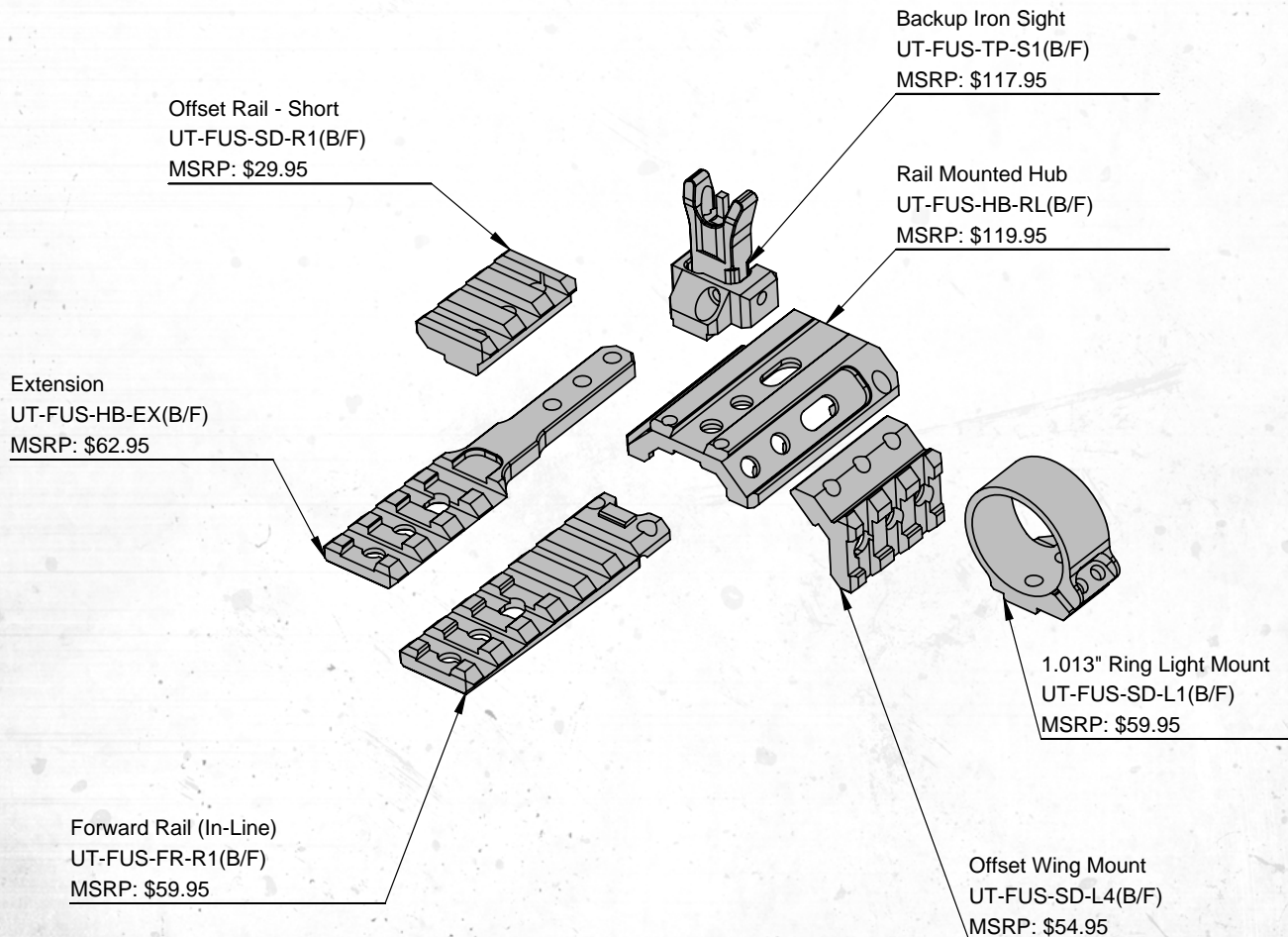

All FUSION parts available
in Flat Dark Earth or Black



www.UnityTactical.com
www.facebook.com/UnityTacticalLLC



SIMPLE. STRONG. CUSTOM.

ATTACHMENT GUIDE

OFFSET RAIL - SHORT - UT-FUS-SD-R1

Surefire X Series
Streamlight TLR Series
Inforce WML
Offset Optics
Pressure Switch
+ More

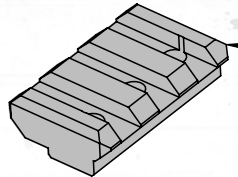

EXTENSION - UT-FUS-HB-EX

Surefire X Series
Surefire Scout Series
Surefire RAID
Streamlight TLR Series
Ring Light Mount - UT-FUS-SD-L1
Pressure Switch
Inforce WML
Inforce APL
+ More

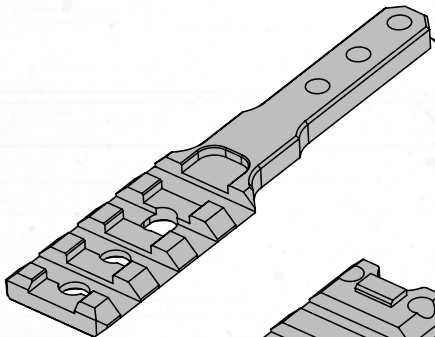

FORWARD RAIL - INLINE - UT-FUS-FR-R1

Surefire X Series
Surefire Scout Series
Streamlight TLR Series
Ring Light Mount - UT-FUS-SD-L1
Pressure Switch
Inforce WML
Inforce APL
Backup Iron Sights
+ More

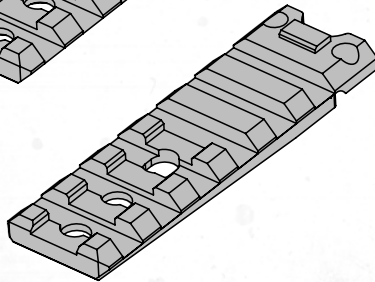

OFFSET WING MOUNT - UT-FUS-SD-L4

Surefire X Series
Surefire Scout Series
Surefire RAID Series
Streamlight TLR Series
Ring Light Mount - UT-FUS-SD-L1
Pressure Switch
Inforce WML
Inforce APL
+ More

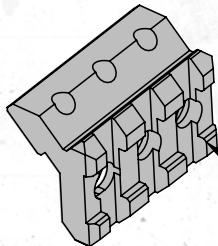

RING LIGHT MOUNT - UT-FUS-SD-L1

1" Diameter Lights
Surefire P2x Fury
Surefire G2 Series
Surefire 6P Series
Inforce 6vx Series
Inforce 9vx Series
+ More

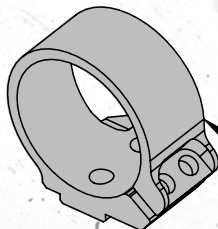

www.UnityTactical.com
www.facebook.com/UnityTacticalLLC